

Single

Twin



A) Unclip terminal block cover (on base of fitting) with screwdriver
B) Thread supply cable through the pre-fitted gland
C) Connect L & N wires to push fit terminal block

Thread cable through gland

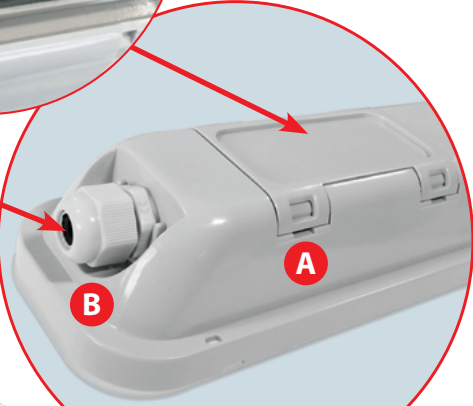

C

B

A

Eterna ELEDWP5

 This luminaire contains built-in LED lamps.

A++

A+

A

B

C

D

E

LED

The lamps cannot be changed in the luminaire.

874/2012 

SFT LED WEATHERPROOF FITTINGS

- Polycarbonate housing and diffuser
- Multiple fixing options - supplied with surface mounting brackets and suspension hooks
- Push fit terminal connections at both ends to facilitate series wiring
- Supplied with 16mm glands, one supplied fitted and one loose for use if series wiring is required

• **SINGLE** = M.O.M: 1 / O.P.Q: 12
• **TWIN** = M.O.M: 1 / O.P.Q: 8

Push fit terminal connections at both ends

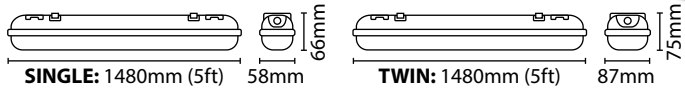

Code	Version	Colour	Wattage	Colour Temp.	Luminaire Lumens	Avg. Rated Life (Hrs)	IP Rating	Energy Rating
ELEDWP5SIN	Single	Grey	30W	4000K	3000 lm	30,000 hrs	IP65	A+
ELEDWP5TWI	Twin		48W		4000 lm			

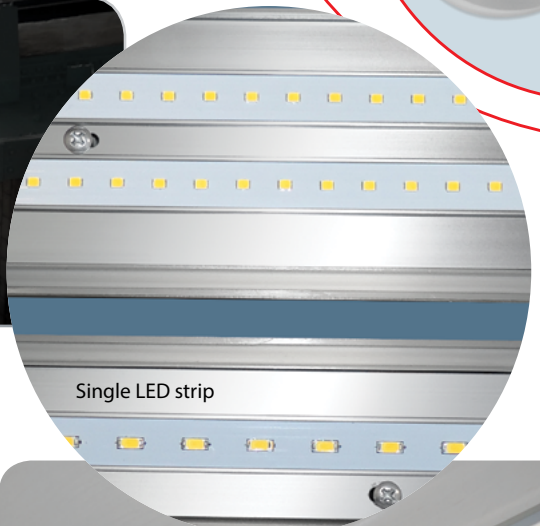

Twin

Single

LED LAMP SPECIFICATIONS:	SINGLE	TWIN
Luminaire lumens (with diffuser)	3000 lm	4000 lm
Lumens from chip (no diffuser)	3800 lm	4800 lm
Useful lumens	2850 lm	3800 lm
Rated Wattage	30W	48W
Rated luminous flux	2850 lm	3800 lm
Nominal life time of the lamp	30,000 hrs	30,000 hrs
Colour temperature	4000K	4000K
Number of switching cycles before premature lamp failure	>15,000	>15,000
Warm-up time up to 60% of the full light output	Instant full light	Instant full light
Dimmable	No	No
LED array dimensions (L/W)	1455 x 12mm	2x 1455 x 12mm
Nominal beam angle	120°	120°
Rated power	30W	48W
Rated lamp lifetime	30,000 hrs	30,000 hrs
Lamp power factor	>0.9	>0.9
Lumen maintenance factor at end of nominal life	70%	70%
Starting time	<0.5	<0.5
Colour rendering	>80	>80
Colour consistency	Within a six step Macadam ellipse	Within a six step Macadam ellipse
Rated peak intensity	825cd	1319cd
Rated beam angle	120°	120°
Voltage / Frequency	240V~50Hz	240V~50Hz

Not suitable for accent lighting