

LAMP SPECIFICATIONS:	
Lumens total flux	300 lm
Lumens 90° flux	260 lm
Rated Wattage	20W
Rated luminous flux	260 lm
Nominal life time of the lamp	2,000 hrs
Colour temperature	2700K
Number of switching cycles before premature lamp failure	10,000
Warm-up time up to 60 % of the full light output	Instant full light
Dimmable	No
Lamp dimensions (Ø/W)	30 x 8mm
Nominal beam angle	38°
Rated power	20W
Rated lamp lifetime	2,000 hrs
Lamp power factor	≥0.5
Lumen maintenance factor at end of nominal life	>75%
Starting time	<0.2s
Colour rendering	99%
Rated peak intensity	320cd
Rated beam angle	38°

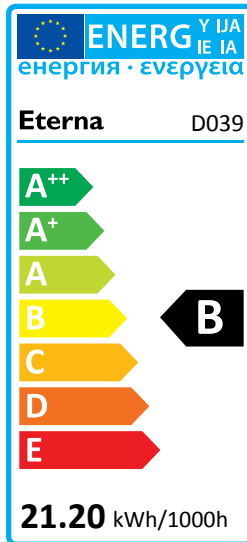

Eterna D039

This luminaire is compatible with bulbs of the energy classes:

This luminaire is sold with a bulb of the energy class: **B**

874/2012



INSTALLATION INSTRUCTIONS

A guide for qualified electricians

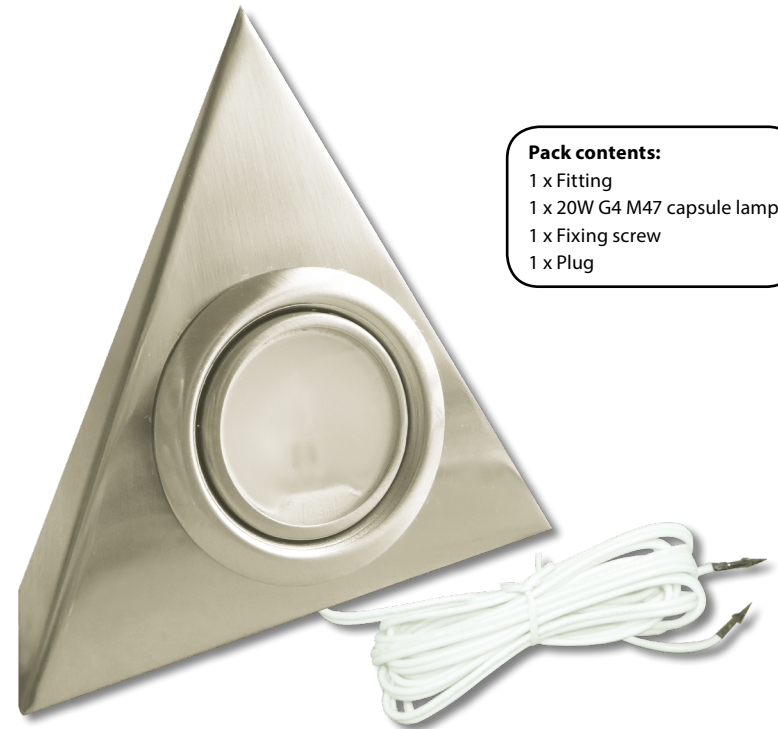

Pack contents:

- 1 x Fitting
- 1 x 20W G4 M47 capsule lamp
- 1 x Fixing screw
- 1 x Plug

Model:
D039

Low Voltage Triangle Light

These instructions are provided as a guideline to assist you.

PLEASE READ THESE INSTRUCTIONS BEFORE INSTALLATION AND RETAIN FOR FUTURE REFERENCE

EVENTUALLY, YOU MAY WANT TO REPLACE THIS PRODUCT:

Regulations require the recycling of Waste from Electrical and Electronic Equipment (European "WEEE Directive" effective August 2005—UK WEEE Regulations effective 2nd January 2007). Environment Agency Registered Producer: WEE/ GA0248QZ.

WHEN YOUR PRODUCT COMES TO THE END OF ITS LIFE OR YOU CHOOSE TO REPLACE IT, PLEASE RECYCLE IT WHERE FACILITIES EXIST - DO NOT DISPOSE WITH HOUSEHOLD WASTE.

CLEANING:

Clean this light fitting only with a soft dry cloth.

Do not use any chemical or abrasive cleaners.

IF YOU EXPERIENCE PROBLEMS:

If you believe your product is defective, please return it to the place where you bought it. Our Technical Team will gladly advise on any Eterna Lighting product, but may not be able to give specific instructions regarding individual installations.

For breakage information visit:
www.eterna-lighting.co.uk



Issue 2014



FOR PRODUCT ADVICE:

- T: 01933 673 144
- F: 01933 678 083
- E: sales@eterna-lighting.co.uk

Visit our website:

www.eterna-lighting.co.uk

READ THIS FIRST:

Check the pack and make sure you have all of the parts listed on the front of this booklet. If not, contact the outlet where you bought this product.

This product contains glass, care must be taken when assembling, fitting or handling to prevent personal injury or damage to the product.

This product must be installed by a competent person in accordance with the current building and IEE wiring regulations.

As the buyer, installer and/or user of this product it is your own responsibility to ensure that this fitting is fit for the purpose for which you have intended it. Eterna Lighting cannot accept any liability for loss, damage or premature failure resulting from inappropriate use.

This product is designed and constructed according to the principles of the appropriate British Standard and is intended for normal domestic service. Using this fitting in any other environments may result in a shortened working life, for example where there is prolonged periods of use or higher than normal ambient temperatures such as lighting public or shared spaces or in nursing / care home facilities.

Suitable for indoor use only.

This product is only suitable for use in living areas (not for areas constantly subject to moisture).

This product is suitable for installation on surfaces with normal flammability (indicated by the "F" in a triangle) e.g. wood, plasterboard, masonry. It is not suitable for use on highly flammable surfaces (e.g. polystyrene, textiles).

Use only with a suitable 240V / 12V step down transformer.

Do not connect lights directly to the mains.

Do not overload the transformer, check that the total wattage of all fittings does not exceed the maximum marked on the transformer.

Before making fixing hole(s), check that there are no obstructions hidden beneath the mounting surface such as pipes or cables.

If the location of your new fitting requires the provision of a new electrical supply, the supply must conform with the requirements of the latest edition of the IEE wiring regulations.

Do not cover the fitting and / or transformer with any insulating materials.

The transformer should be placed where it cannot be splashed.

This fitting uses SELV (Safety Extra Low Voltage). Do not connect any part to earth.

The fitting must be positioned so that there is at least 0.3m (300mm) between the bulb and any illuminated surface. Do not use the fitting without the safety shield fitted.

When replacing the lamp, do not touch with bare fingers, grip the lamp with a tissue or clean soft cloth.

Do not attach to surfaces which are damp, freshly painted or otherwise electrically conductive (e.g. metallic surfaces).

LAMP REPLACEMENT:

Switch off the electricity at the mains.

Remove the glass diffuser by prizing the metal ring that retains it out of the fitting using a small flat bladed screwdriver.

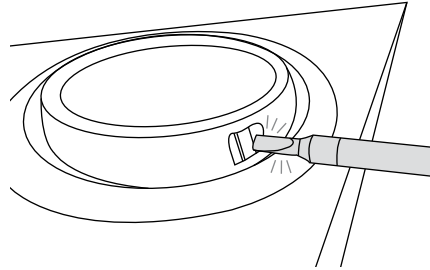

Pull the old lamp straight out of its socket and replace only with one of the same type and rating.

IMPORTANT! Do not touch the lamp with bare fingers, use a soft clean cloth or tissue.

Replace the glass diffuser pressing firmly back into place.

REPLACEMENT LAMP TYPE:

Fitting requires 1 x suitable 12V G4 M47 halogen capsule.

Fitting is rated at 20W max.

ASSEMBLING THE PLUG:

Once you have threaded the cables from your light to your transformer, you will need to push the pins at the ends of your cables into the plug body.

NOTE: Once the pins have been inserted they cannot be removed.

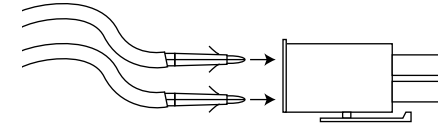

INSTALLATION:

- 01) Check that the transformer you intend to use to power your fitting is adequately rated for the total number of fittings you are installing and that it has been installed in accordance with all of the manufacturers instructions.
- 02) Choose the location for your new fitting.
- 03) Prepare the route for the cable between the light and the transformer.

04) Extract the light(s) from the triangle surround by gently levering it out using a small screwdriver or other flat bladed implement. Take great care not to damage the decorative finish.

05) With the cable(s) threaded through the surround, secure the surround in position using suitable fixings appropriate to the mounting surface.

06) Gently pull the cable(s) through your prepared exit route and press the light fitting(s) back into the surround. Make sure that you do not trap a loop of cable behind the light fitting(s).

07) Make the connection of the cable to the transformer. We recommend the use of an Eterna Lighting transformer which has sockets designed to allow the plug(s) fitted to your light(s) to plug directly in.

Note: If you have any other transformer in which there is no provision for connection using the plug fitted to your light, you will need to cut the plug off and use an alternative method of connection. The connections to the light fitting are not designated Live or Neutral. Make connections using a terminal block, ensure that there are no strands of wire protruding and wrap well with insulating tape.

08) Restore the power and switch on.

